

技术参数:

- 产品系列: M12 A-code
- 插针数: 4
- 额定电流(40°C): 4A
- 额定电压: 250V
- 额定脉冲电压: 2500V
- 污染等级: 3
- 接触电阻:  $\leq 3m\Omega$
- 绝缘电阻:  $\geq 100M\Omega$
- 锁紧方式: 螺纹式M12\*1
- 电缆类型: PVC, 黑色RAL9005
- 线规:  $0.34mm^2$  (AWG22)
- 防护等级: IP67
- 插拔次数:  $\geq 100$
- 温度范围:  $-25^\circ C \dots +85^\circ C$
- 外壳材料: TPU
- 插体材料: PA
- 插针材料: 铜合金
- 插针电镀材料: 金

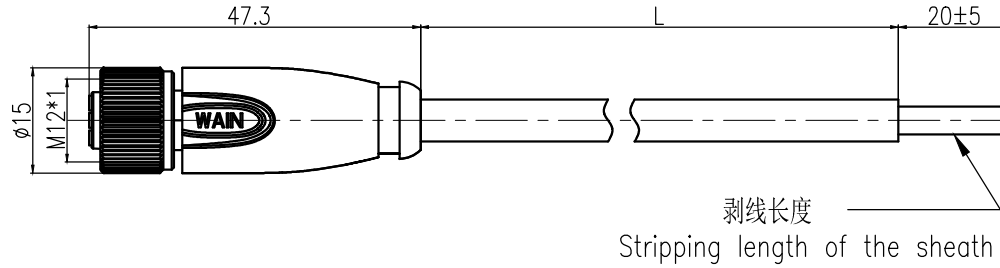

Technical specification:

- Series: M12 A-Code
- Number of contacts: 4
- Rated current (40°C): 4A
- Rated voltage: 250V
- Rated impulse voltage: 2500V
- Pollution degree: 3
- Contact resistance:  $\leq 3m\Omega$
- Insulation resistance:  $\geq 100M\Omega$
- Connector locking system: screw M12\*1
- Cable type: PVC, Black RAL 9005
- Wire gauge:  $0.34mm^2$  (AWG22)
- Degree of protection: IP67
- Mating cycles:  $\geq 100$
- Temperature range:  $-25^\circ C \dots +85^\circ C$
- Material of housing: TPU
- Material of insert: PA
- Material of contact: copper alloy
- Contact plating: Au

例如型号”M12-F03A-T-L-PVC-SH”,  
 ”L”表示带线长度, 单位m.

Ex: Part code ”M12-F03A-T-L-PVC-SH”,  
 the ”L” represents the cable length, unit m.

针位图 Contact arrangements

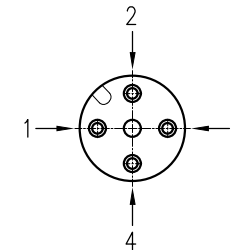

接线图 Circuit diagram

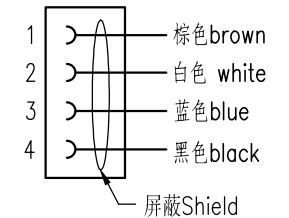

						表面处理 Finish		-		图号 Drawing No.		-	
						材料 Material		-		产品代号 Part Code		M12-F04A-T-1.5-PVC-SH	
标记 Mark	处数 Number	变更描述/Description		签名 Signature	日期 Date	比例 Scale		版本 REV.	重量 Weight	数量 Qty.	产品料号 Part No.		1630044024021
绘图 Drawn	ZQ XU	15.03.2015	标准化 Stand.	-	-	1:1	V2.0	82g	-	产品名称 Part Name		-	
审核 Checked	ZM LIN	15.03.2015								All Dimensions in mm Original Size DIN A 4		厦门唯恩电气有限公司 XIAMEN WAIN ELECTRICAL CO.LTD	
工艺 Process	-	-	批准 Approved	YY LUO	15.03.2015								